



TOUCH 02 L1

Power supply units and control gears - Alimentatori ed elettronica di controllo

Technical specs:

TOUCH 02L1 RGBW Touch Panel

Input Voltage: 100~240Vac
 Output Signal: DMX512
 Working Temp.: -30°C ~55°C
 Dimensions: L86×W86×H36 (mm)
 Weight(G.W.): 225g

Changing Mode Key

1. Static Red
2. Static Green
3. Static Blue
4. Static Yellow
5. Static Purple
6. Static Cyan
7. Static White
8. RGB Jumping
9. 7 Colors Jumping
10. RGB Smooth
11. 7 Colors Smooth
12. Static Black (only turn off RGB)

DMX512 addresses:
 Zone 1: adrss 1/2/3/4

Functions:

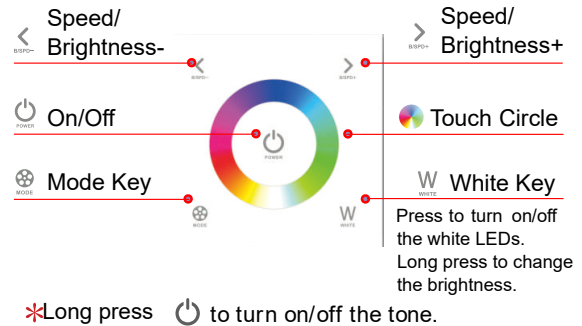

Installation Instruction:

90x90x50 mm



compulsory outercasing
WC0302

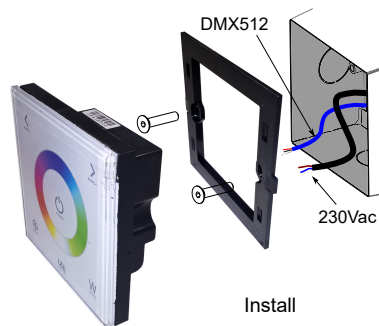

Install



Uninstall

Connection:



100-240Vac
 mains

DMX512 signal: zona 1 shielded
 and twisted cable 2x0.5



TOUCH 02 L1

Power supply units and control gears - Alimentatori ed elettronica di controllo

Dati tecnici:

TOUCH 02L1 RGBW Touch Panel

- Input: 100~240Vac
- Segnale uscita: DMX512
- Temp.funzionamento: -30°C ~55°C
- Dimensioni: L86×W86×H36(mm)
- Peso: 225g

Programmi:

1. Rosso
2. Verde
3. Blue
4. Giallo
5. Rosa
6. Ciano
7. Bianco R+G+B
8. RGB Jumping
9. Cambio 7 colori a salto
10. Variazione RGB morbida
11. Cambio 7 colori morbido
12. Spegnimento R+G+B (uso bianco 4° ch)

Indirizzi DMX512:

Zona 1: adrss 1/2/3/4

Funzioni:

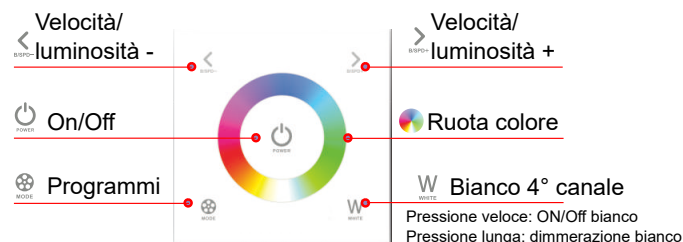

* Pressione prolungata per spegnere i toni pulsante

Installazione:

90x90x50 mm



cassaforma obbligatoria
WC0302

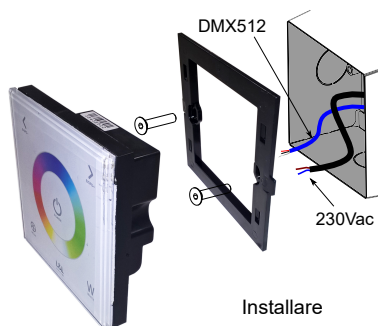

Installare



Disinstallare

Connessione:



100-240Vac
Alimentazione

Segnale DMX512: zona 1
usare cavo schermato 2x0.5